

903834



TENNESSEE DEPARTMENT OF ENVIRONMENT AND CONSERVATION
APPLICATION FOR GROUND WATER PROTECTION SERVICES

Table with columns: SERVICE REQUESTED (check service), APPLICANT COMPLETE QUESTIONS, FEES DUE, PTBMIS CODES V689 Code Supp/Code. Includes rows for Septic System Construction Permit, Water Sample, Alternative System Permit, etc.

*Applicant may review these service requests with Environmental Specialist prior to processing application.

2. LANDOWNER: Names: Willis F. Brown; APPLICANT: Name: Willis F. Brown; ORIGINAL OWNER: Name: Sue H. Clay. Address: RT. 12 BOX 520 CROSSVILLE TN 38555. Day Phone: 456-6426.

3. LOCATION OF LOT OR SITE: a) In a subdivision? [checked] b) Name: TANSI-GERONIMO II Lot # 657 & 658.

4. FOR SSDS PERMIT ONLY: a) Size of lot 170' X 160'; b) Number of Bedrooms 2; c) How many occupants?; d) Excavated Basement? Yes No [checked]; e) Basement Plumbing Fixtures? Yes No [checked]; f) Amount of water used monthly (gallons); g) Water Supply: Public [checked] Well Spring; h) Is the lot staked? YES If not, date it will be staked; i) Installer, if known: Charlie Braslin.

5. FOR INSPECTION LETTER ONLY: Will pick up Please mail; a) Age of house; b) Is house vacant? How long?; c) Original sewage system inspected by Health Department?; d) Date of previous repairs Inspected; e) Is waste water "backing up" into plumbing fixtures? Surfacing on the ground?; f) All waste water including washing machines routed into septic tank.

6. FOR WATER SAMPLE ONLY: a) Source of Supply: Spring Well; b) Is there an outside faucet?; c) Is the source chlorinated?; d) For Wells: Is the casing 6" above the ground? Is a sanitary seal on the casing?

7. MAKE A ROUGH SKETCH ON BACK OF THIS PAGE SHOWING DIRECTIONS TO PROPERTY, PROPERTY LINES, HOUSE SITE, WELL LOCATION, SPRING LOCATION, PLANNED DRIVEWAY AND UTILITIES.

8. ALL FEES DUE IN ADVANCE AND ARE NON-REFUNDABLE (except upon appeal). See Fee Schedule on reserve. Make check payable to: TREASURER, STATE OF TENNESSEE

9. I certify that the above information is true and correct to the best of my knowledge, and that I have been authorized by the above named landowner to submit this Application for Environmental Services to the Division of Ground Water Protection.

DATE: 4.21.95 SIGNATURE: Willis F. Brown AMOUNT PAID: \$ 100.00 RECEIPT NUMBER: 61728

White: File Canary: Owner

Check

FEE SCHEDULE

		PTBMIS SUPP/CODE
Evaluation for Conventional or LDGP Septic System Permit	\$100.00 up to 1000 gpd	
	\$ 50.00 for each additional 1000 gpd or portion thereof	78066
Repair	\$None	
Inspection Letter	\$100.00	
Subdivision Evaluation	\$ 20.00 per lot	
Water Samples:		
Total Coliform	\$ 25.00	78036P
Fecal Coliform	\$ 50.00	78036P
Soil Mapping:		
Low Intensity	\$ 65.00 up to 5 acres	78074
	\$ 10.00 per acre thereafter	78076
General Intensity	\$ 40.00 per acre — \$ 40.00 minimum	78078
High Intensity	\$ 65.00 per acre — \$ 65.00 minimum	78040
Extra High Intensity	\$ 100.00 per acre — \$100.00 minimum	78042
	(Minimum is for each separate acre or part of acre to be mapped)	
Alternative System Application Processing	\$150.00 up to 1000 gpd	
	\$ 75.00 for each additional 1000 gpm or portion thereof	78070
Large Conventional or Large Alternative Plan Review	\$300.00 per proposed system	
Experimental System Application Processing	\$250.00	
Pumper Permit	\$100.00	
Installer Permit	\$100.00 for conventional & LDGP	
	\$ 50.00 for each alternative system	78080
Plat Approval — Individual Lots	\$ 20.00 per lot	78029
Domestic Septage Disposal Site Permit	\$200.00	78031

SKETCH

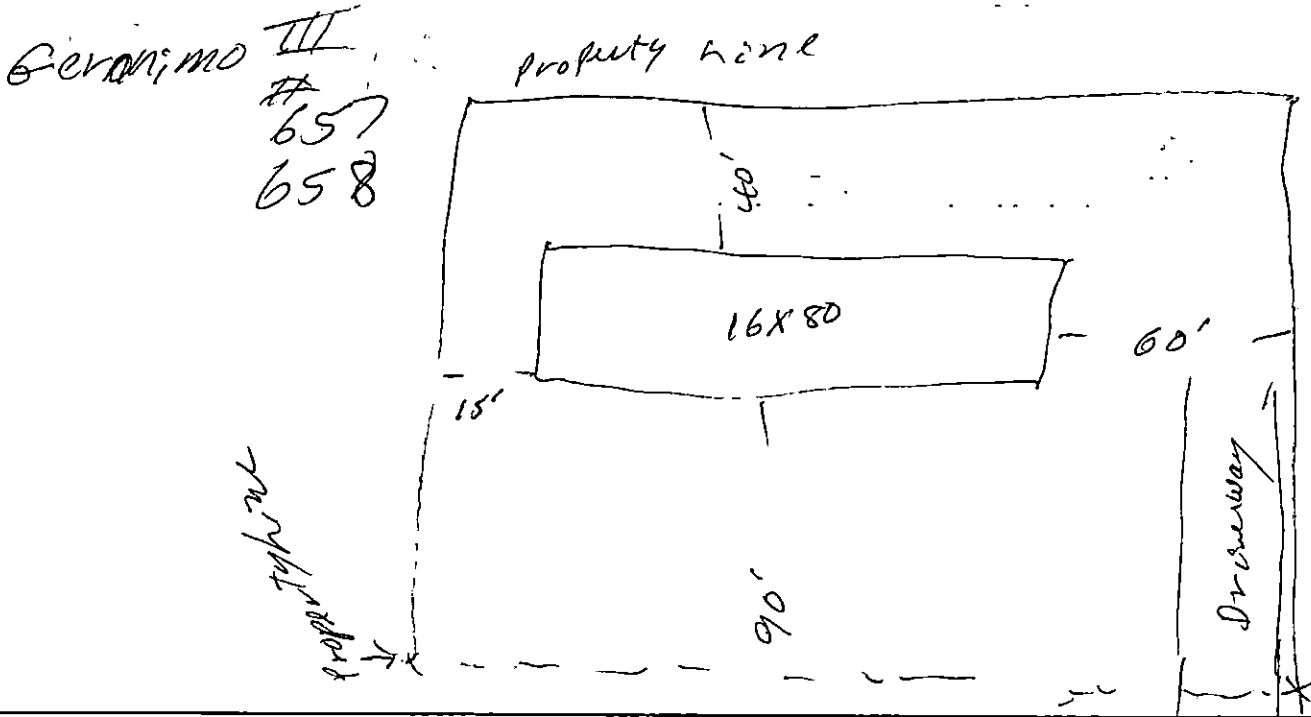

Official Use:

File Search
 Absorption Rate _____ At Depth _____
 Percolation Rate _____ At Depth _____
 Other Requirements

**TENNESSEE DEPARTMENT OF ENVIRONMENT AND CONSERVATION
DIVISION OF GROUND WATER PROTECTION
PERMIT FOR CONSTRUCTION OF SUBSURFACE SEWAGE DISPOSAL SYSTEM**

Issued to: <u>Willis F. Brown</u> <small>Owner, Developer, Contractor, Installer, Etc.</small> Location: <u>L. TANS: Village</u> <u>GERONIMO III LOTS 657/658</u> <u>COMBINED</u> Installation: <input checked="" type="checkbox"/> 1. New Installation <input type="checkbox"/> 2. Repair to Existing System Establishment: <input checked="" type="checkbox"/> 1. Residential: # Bedrooms <u>2</u> <input type="checkbox"/> 2. Other: _____ <small>(specify)</small> Gal/Day _____	Evaluation Based Upon: <input type="checkbox"/> 1. Soil typing by Soil Scientist <input type="checkbox"/> a. General <input type="checkbox"/> b. High Intensity <input type="checkbox"/> c. Extra High Intensity <input type="checkbox"/> 2. Soil Percolation Test <input type="checkbox"/> 3. Environmental Specialist Estimated Absorption Rate: _____ MPI	Type of System: <input checked="" type="checkbox"/> 1. Conventional <input type="checkbox"/> 2. Low Pressure Pipe <input type="checkbox"/> 3. Mound <input type="checkbox"/> 4. Lagoon <input type="checkbox"/> 5. Large Diameter Graveless Pipe <input type="checkbox"/> a. Sand backfill required <input type="checkbox"/> 6. Other
Approval based upon: Statute No. <u>T.C.A. 68-221-403</u> <input type="checkbox"/> (c) Percolation test <input checked="" type="checkbox"/> (d) Grandfather clause, Current standards except those specified <input type="checkbox"/> (f) 12" (karst) and 6" (non-karst) buffer required <input type="checkbox"/> (i) 9" buffer required (24"-36" total soil depth) <input type="checkbox"/> (k) Grandfather clause — meets June 30, 1990 standards (repair only) <input type="checkbox"/> Other _____		

This system shall consist of a two compartment septic tank holding 750 gallons, with 250 linear feet in _____ trenches, 36 inches wide and 24 inches deep. (Depth of gravel: 12 inches)

Also required:
 1. Soil Improvement Practice (SIP)
 2. Flow Diversion Valve
 3. Sewage Pump
 4. Other: _____

All installers of subsurface sewage disposal systems must hold a valid annual license from the Tennessee Department of Environment and Conservation.

The recipient of this permit agrees to construct or have constructed the above described system in accordance with T.C.A. 68-221-401 et. seq. and The Regulations To Govern Subsurface Sewage Disposal Systems. If any part of the system is covered before being inspected and approved, it shall be uncovered by the recipient of the permit at the direction of personnel of the Department of Environment and Conservation. Any cutting, filling or alterations of the soil conditions on the aforementioned property after this day may render this approval null and void.

Willis F. Brown Date 4-24-95
(Signature of Recipient)
 Issued at Crossville Tennessee, in Cumberland County
 By J. Michael Ledbetter Env Spec IV Date 24 April 95
(Name and Title) (Date of Issue)

Utility water This permit is valid for 3 years from date of issue.

Notes
 Disposal lines on contour
 Permit is for approved s/d without appraisal data

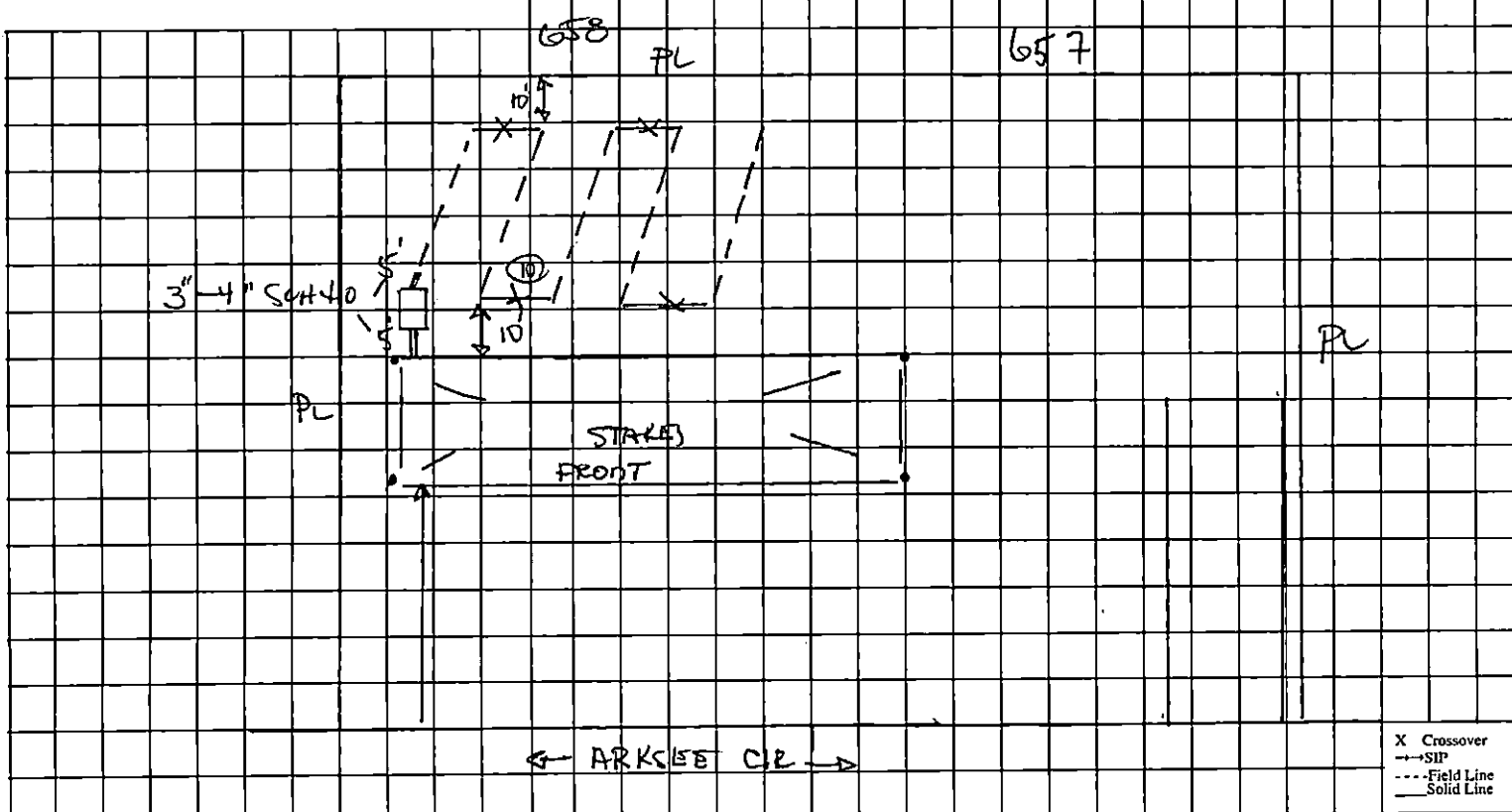



CERTIFICATE OF COMPLETION OF SUBSURFACE SEWAGE DISPOSAL SYSTEM

Issued to: WILLIS F. BROWN
Owner, Developer, Contractor, Installer, Etc.

Location: LAKE TANSI VILLAGE
GERONIMO III LOTS 657/658
COMBINED

Type of system
 1. Conventional
 2. Low Pressure Pipe
 3. Mound
 4. Lagoon
 5. Large Diameter Gravelless Pipe
(a) Sand backfill required Yes () No ()
 6. Other
SCHUBERTS 2 COMP. PRE CAST 75Ø Septic Tank
(type) (volume)
 Estimated Absorption Rate TCA - 68-221-403 D
(minutes per inch)
 New Installation Repair Other
 Installed by: CHARLIE GRIFFITH

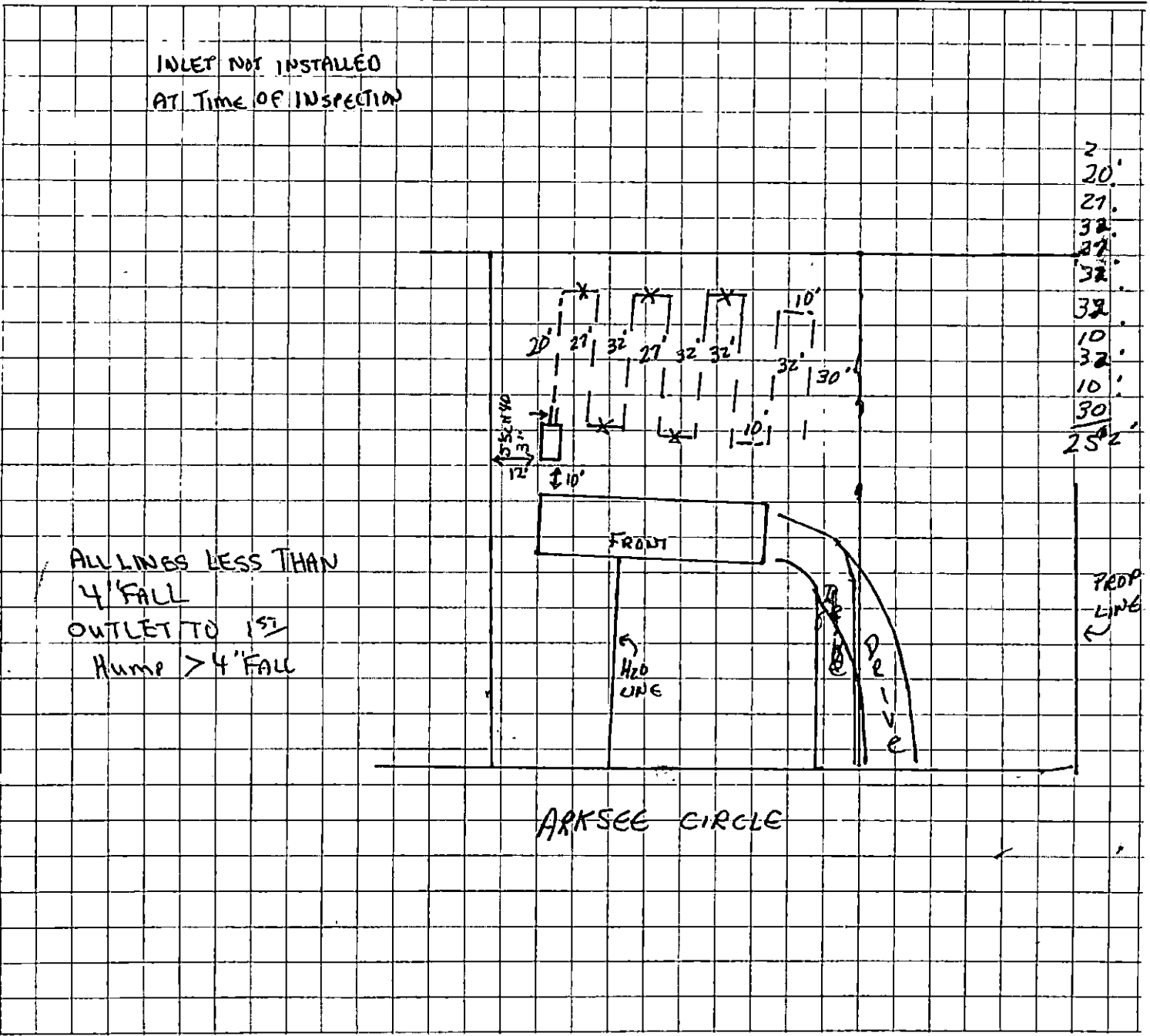

Construction Approved By: Douglas W. Davis Env. Spec. III 4/27/95
(Name and Title) (date)